

STAINLESS STEEL TANKS



Minnesota Wanner Company builds stainless steel tanks for truck, skid and trailer mounted sprayers. Tanks are made from heavy gauge stainless steel and precision welded. Features available include: sight gauges, multiple compartments, baffles, storage compartments and mechanical agitation.

Call or write factory with your specific size and gallonage requirements for a prompt quotation.



STAINLESS STEEL



Multiple compartments and dry storage areas add versatility without detracting from professional appearance.



All stainless steel, one piece sills and decking or sills only for direct chassis or flatbed mounting.

MECHANICAL AGITATION ASSEMBLY



Tanks

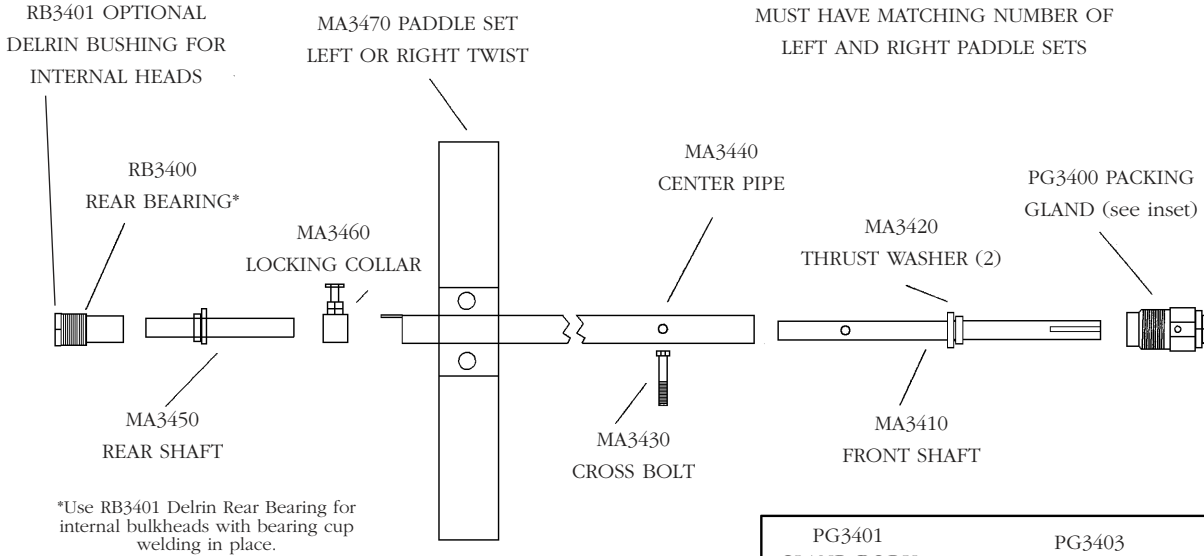

MUST HAVE MATCHING NUMBER OF LEFT AND RIGHT PADDLE SETS

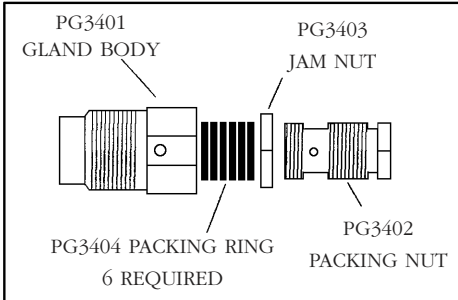

NOT SHOWN:

MA 3480 DELRIN MIDDLE BEARING (for long tanks)
PG3410 PACKING GLAND WITH FRONT SHAFT

MA 3400 MECHANICAL AGITATION

Replacement assemblies for Minnesota Wanner tanks and others using 3/4" shafts.
Stainless steel wetted parts and brass packing glands for long life.

SINGLE CAM MANHOLE



#16MHASY

- Full 16" opening.
- All stainless steel construction.
- Center mounted arm with single cam. (16" Buna Rubber Gasket #1106-16)
- Removeable 12" polyethylene inner lid.

4 CAM MANHOLE



#LG2311

- Full 16" opening.
- Stainless steel wetted parts.
- 4 adjustable cam handles.
- Mechanical vent.
- Safety catch.

1-800-247-4998